

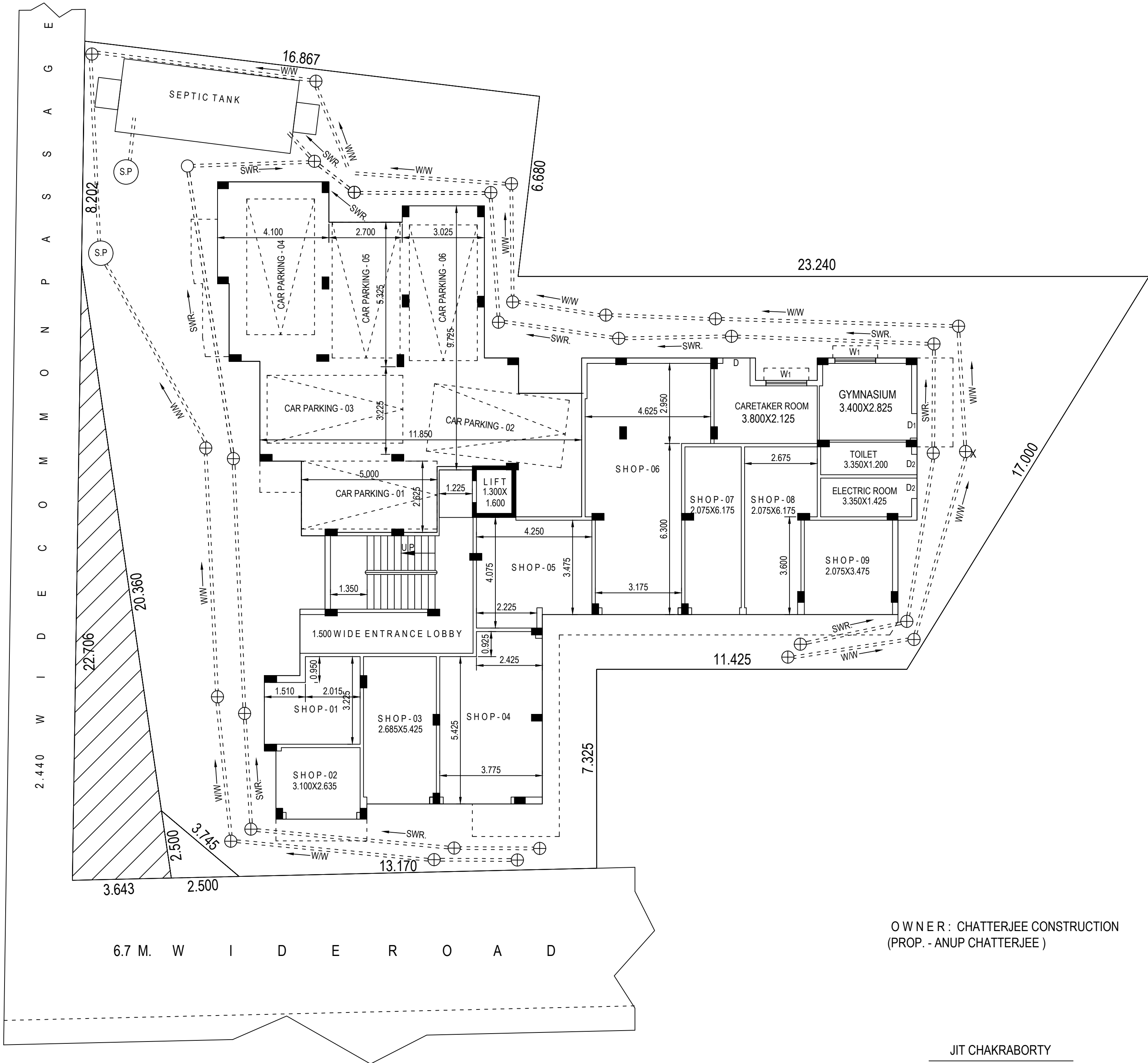

PLAN SHOWING THE SEWAGE LINE OF G+III STORIED BUILDING OF CHATTERJEE CONSTRUCTION AT MOUZA - SONARPUR, J.L NO.- 39, R.S & L.R DAG NO.- 1905, R.S KHATIAN NO.- 114, L.R KHATIAN NO.- 4260, HOLDING NO.- 1533 RADHAGOBINDAPALLI, WARD NO.- 12 UNDER RAJPUR - SONARPUR MUNICIPALITY, P.S - SONARPUR, DIST.- SOUTH 24 PARGANAS, KOL.-700150.SCALE - 1:100.



OWNER : CHATTERJEE CONSTRUCTION  
(PROP. - ANUP CHATTERJEE )

JIT CHAKRABORTY  
CONSULTANT

